

1Kn
WA2-4 JE-09
JE-09 (W2,E1)
DAK
Nisthilfe

(286.7)
- 283.9 -

2Kn
T1-2 JE-09
JE-09 (W2,E1)
DTK

(274.4)
- 274.4 -

3Kn
T1-2 JE-09
JE-09 (W2,E1)
DTK

(299.9)
- 299.9 -

4Kn
T1-2 JE-09
JE-09 (W2,E1)
DTK

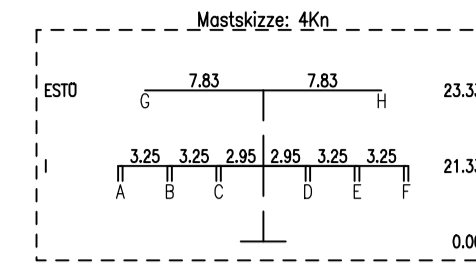
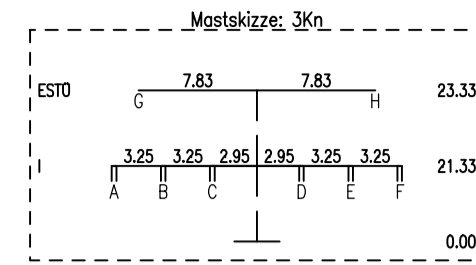
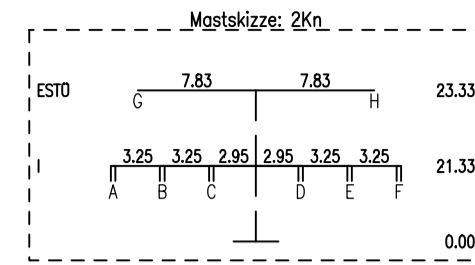
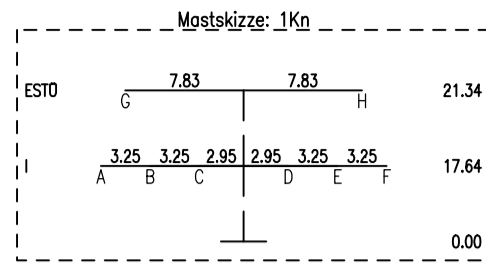

| SI Ebene | Traverse |
|----------|----------|
| A I | 9.45 re. |
| B I | 6.20 re. |
| C I | 2.95 re. |
| D I | 2.95 re. |
| E I | 6.20 re. |
| F I | 9.45 re. |
| G ESTD | 7.83 re. |
| H ESTD | 7.83 re. |

| Lastfallliste | |
|---------------|-------------------------|
| L1 | 80° +40k(KRD) |
| L2 | -5° FUZ +40k(KRD) |
| L3 | 40° |
| L4 | 40° Wind(Gus) +40k(KRD) |
| L5 | -5° Eis +40k(KRD) |

215.08 GRAD
236.98 GUN

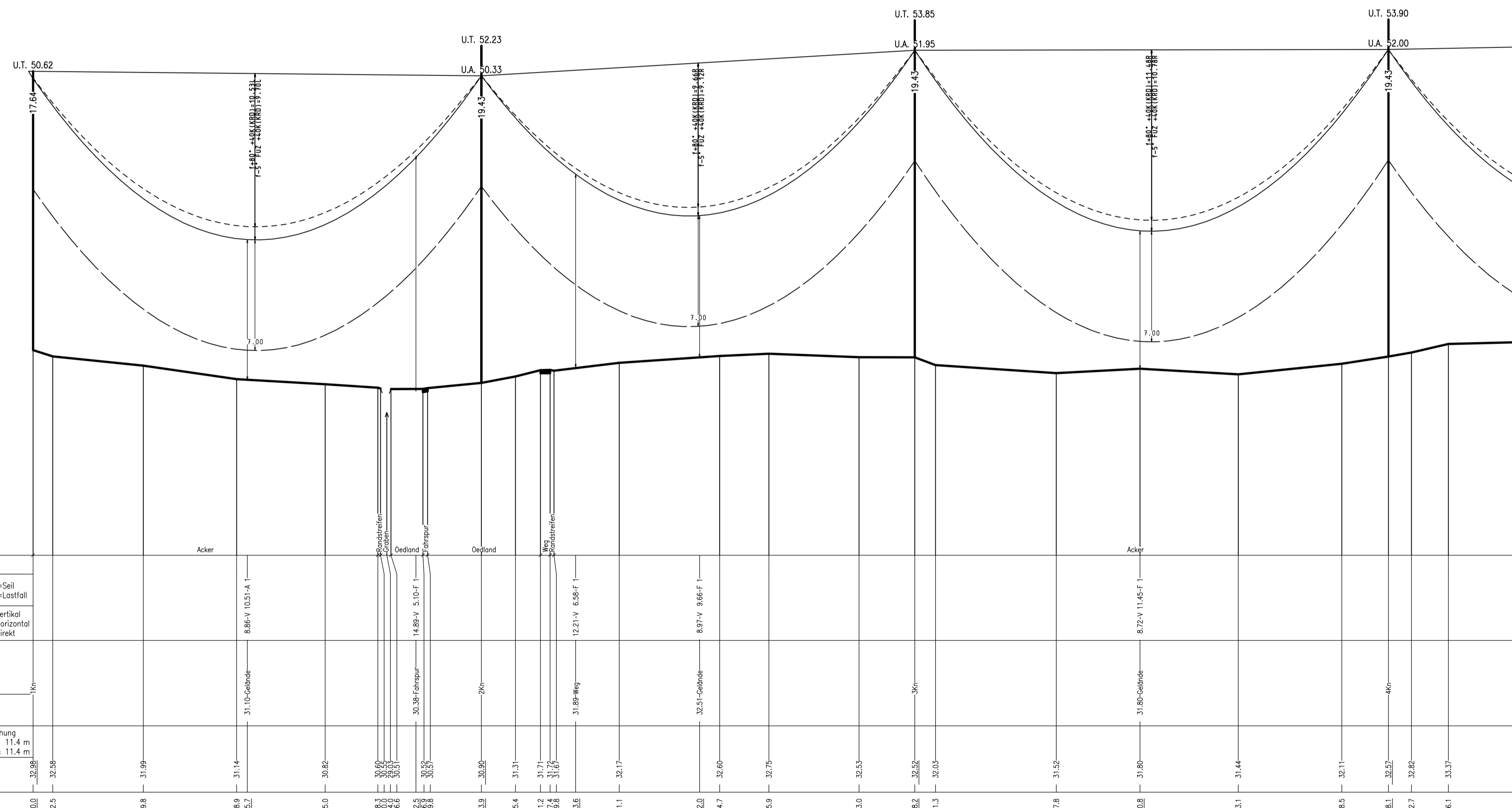

Höhenanschluß:
Herkunft : L'Vern Geo Brandenburg
Lage : A=L=Seil
1-9=Lastfall
Art, Nr. : GPS (Smart Net)
Höhe d. NNH :
Letzte Festl. : 2016

| Nutzungsart | Durchhang | Abstand | Objektart | Objekthöhe | Seitliche Oberhöhung | Geländehöhe |
|-------------|-------------------|------------------------------------------|-----------|----------------|-------------------------------|-------------|
| Acker | 8.86 v/ 10.01-A | V=vertikal H=horizontal D=diagonal | 16m | 31.10-Gelände | links 11.4 m rechts 11.4 m | 32.88 |
| Oedland | 14.89 v/ 5.10-F 1 | | | 30.38-Fahrspur | | 32.88 |
| Oedland | 8.9 v/ 9.86-F 1 | | | 26m | | 32.88 |
| Weg | 12.5 v/ 6.58-F 1 | | | 31.89-Weg | | 32.88 |
| Oedland | 8.9 v/ 9.86-F 1 | | | 32.51-Gelände | | 32.88 |
| Acker | 8.29 v/ 11.66-F 1 | | | 31.80-Gelände | | 32.88 |

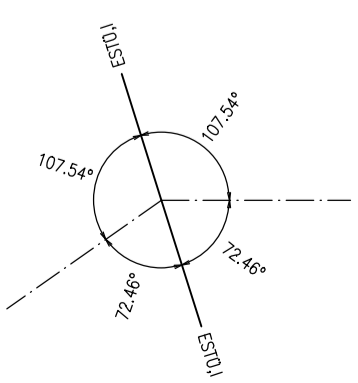
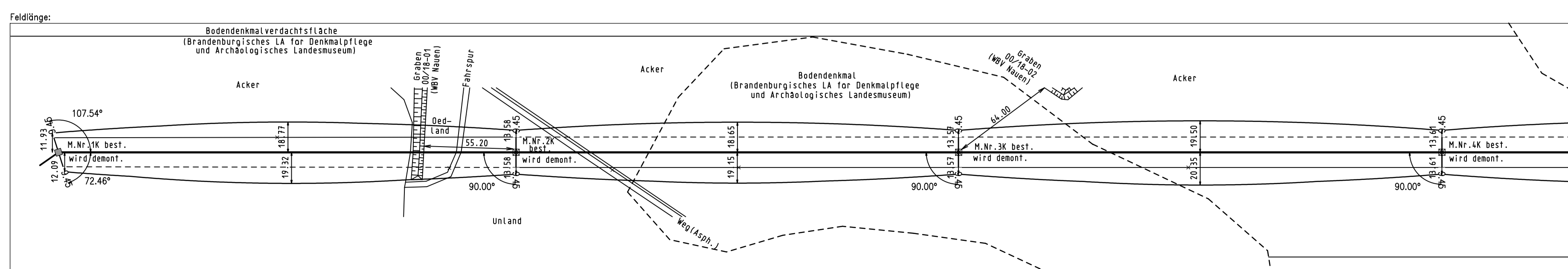

e.dis

110-kV Trasse HT 1041 Abzweig Ketzin

Mast 1Kn - Mast 8Kn

Masttypen: JE-09 (W2,E1)
Berechnungsverfahren Ket, Norm VDE 1/11 HSP, g=10.00 m/s²
1 fache Windlast Zone 2 (SO1-Zug/3J-Aus), 1 fache Eislast (Zone 1)
Lagebezugssystem: ETRS 89, UTM-Zone 33

| SEIL | ART | BUNDEL | TYP / QUERSCHN. | Isolation | AUSL. TEMP. | S ₁ (N/mm²) | S ₂ (N/mm²) | STATUS |
|------|-----|--------|--------------------|---------------------|---------------------|------------------------|------------------------|---------------|
| A | B | 110 | 1 | 264-AL1/34-ST1A | CS160C19L-1270-2480 | 80° +40k (KRD) | 49.02 | 81.00 Soll 17 |
| B | 110 | 1 | 264-AL1/34-ST1A | CS160C19L-1270-2480 | 80° +40k (KRD) | 49.02 | 81.00 Soll 17 | |
| C | 110 | 1 | 264-AL1/34-ST1A | CS160C19L-1270-2480 | 80° +40k (KRD) | 49.03 | 81.00 Soll 17 | |
| D | 110 | 1 | 264-AL1/34-ST1A | CS160C19L-1270-2480 | 80° +40k (KRD) | 49.03 | 81.00 Soll 17 | |
| E | 110 | 1 | 264-AL1/34-ST1A | CS160C19L-1270-2480 | 80° +40k (KRD) | 49.03 | 81.00 Soll 17 | |
| F | 110 | 1 | 264-AL1/34-ST1A | CS160C19L-1270-2480 | 80° +40k (KRD) | 49.03 | 81.00 Soll 17 | |
| G | ES | 1 | 51-AL1/30-ST1A | | 40° | 56.33 | 135.00 Soll 17 | |
| H | SLH | 1 | 51-AL3/21-A20SA 2R | | 40° | 51.27 | 135.00 Soll 17 | |

ES links
LES rechts, 2 Röhren mit je 12 Fasern

| | | | |
|-------------------|-------------------|---------------------------------------------------------------------|-----------------------|
| Baufirma | Trassierungsfirma | E.DIS Netz GmbH Langewahler Straße 60 15517 Forstnwalde/Spree | |
| Revision | Trassierung | Aufg. | Hubain |
| Aufg. | 23.08.16 | Gez. | Baker |
| Gez. | 28.09.16 | Gepr. | Wesennann |
| Gepr. | 10.11.17 | Beneennung | |
| Fortfahrsoriginal | | | |
| Aktualisierung | 06.11.17 | OHS / Si | |
| TOB | 05.12.17 | OHS / Si | |
| M.Skn LES-Muffe | 10.08.18 | OHS / Si | |
| Berechnung | | Datum | Name |
| e.dis | | Zeichnungsnummer | Blatt |
| | | P_HT1041_01Kn_08Kn.PRO | 24/7 |
| Änderung | | Datum | Firma/Bearb. |
| Inhalt: Planung | | Ausgabedatum: 11.02.20 | Ausgabezeit: 14:20:54 |