

# Profilplan

Maßstab der Längen 1:2000  
Maßstab der Höhen 1: 500

von Mast MAST 5 bis Mast Mast 7n

SEIL	ART	BÜNDEL	SEILTYP / QUERSCHNITT	AUSL. TEMP.	S <sub>M</sub> (N/mm <sup>2</sup> )	S <sub>G</sub> (N/mm <sup>2</sup> )	S <sub>S</sub> (N/mm <sup>2</sup> )	STATUS
A	110	1	AL/ST 240/40	80° KR	59.14	93.50	93.50	Ist 23
B	110	1	AL/ST 240/40	80° KR	59.12	93.50	93.50	Ist 23
C	110	1	AL/ST 240/40	80° KR	59.07	93.50	93.50	Ist 23
X	SLH	1	AY/AW LWL 52/25-5.6	40° KR	81.10	179.77	169.00	Soll

Masttypen: HB, JV  
Berechnungsverfahren Ket, Norm VDE 9/19 HSP, q = 9.81 m/s<sup>2</sup>  
1 fache Windlast Zone 2 (50J-Zug/3J-Aus), 1 fache Eislast (Zone 1)  
Auslegungstemperatur = Tmax + KR; Tmax=80°C/40°C; KR = 80 Jahre LS/40Jahre SLH  
Auflegejahr: 1980 LS/2024 SLH

Änderungen	Datum
Einbau Rodurflex-Standardkette, Auflage LWL 52/25	18.04.23

Ausgabe:	25.07.23	08:56:24
Erstellt:	17.04.23	14:04:10
Inhalt:	Planung	

**MAST 5**  
W11+0  
HB  
DAK/DAK

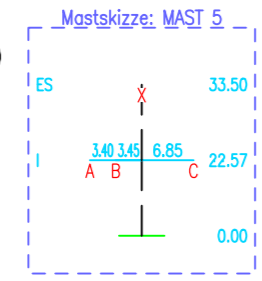

**MAST 6**  
T+0  
HB  
DTK  
WT-Funktion

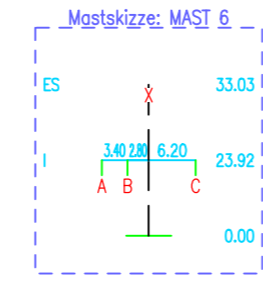

**Mast 7n**  
W61-6  
JV  
DAK/DAK  
Neubau

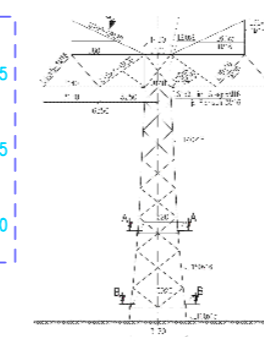
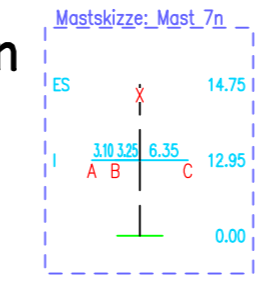

S Ebene	Traverse
A I	6.85 li.
B I	3.45 li.
C I	6.85 re.
X ES	0.00

Lastfallliste	
1	80° KR
2	40° KR
3	40° KR W(aus)
4	-5° Eis KR
5	-5° Fuz KR
6	40° Wind(aus)
7	40°
8	-5° Eis

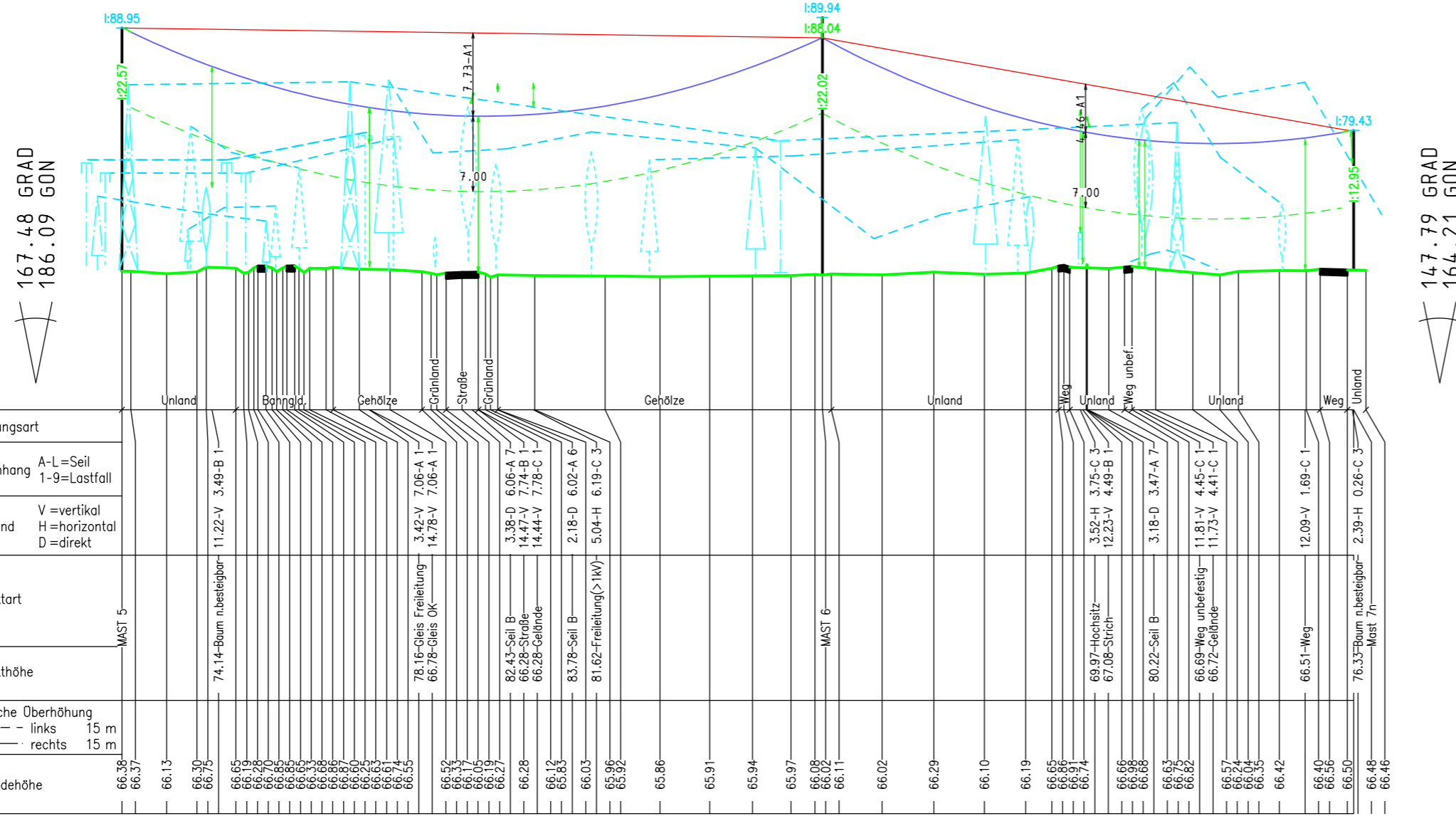

Höhenanschluss:  
Herkunft : per GPS  
Lage :  
Art, Nr. :  
Höhe ü. NHN16 :  
Letzte Festl. :

Nutzungsart	Durchhang	Abstand	Objektart	Objekthöhe	Seitliche Oberhöhung	Geländehöhe
Unland	A-L=Seil 1-9=Lastfall	V=vertikal H=horizontal D=direkt	MAST 5		--- links 15 m --- rechts 15 m	66.38 66.37
Bahngrf.	11.22-V 3.49-B 1					66.15
Gehölze	74.14-Baum abestabgar					66.30 66.29 66.28 66.27 66.26 66.25 66.24 66.23 66.22 66.21 66.20 66.19 66.18 66.17 66.16 66.15 66.14 66.13 66.12 66.11 66.10 66.09 66.08 66.07 66.06 66.05 66.04 66.03 66.02 66.01 66.00
Grünland	3.42-V 7.06-A 1 14.78-V 7.06-A 1					66.32 66.31 66.30 66.29 66.28 66.27 66.26 66.25 66.24 66.23 66.22 66.21 66.20 66.19 66.18 66.17 66.16 66.15 66.14 66.13 66.12 66.11 66.10 66.09 66.08 66.07 66.06 66.05 66.04 66.03 66.02 66.01 66.00
Grünland	3.38-D 6.06-A 7 14.47-V 7.74-B 1 14.44-V 7.78-C 1					66.28 66.27 66.26 66.25 66.24 66.23 66.22 66.21 66.20 66.19 66.18 66.17 66.16 66.15 66.14 66.13 66.12 66.11 66.10 66.09 66.08 66.07 66.06 66.05 66.04 66.03 66.02 66.01 66.00
Grünland	2.18-D 6.02-A 6 5.04-H 6.19-C 3					66.03 66.02 66.01 66.00
Grünland	3.59-H 3.75-C 3 12.23-V 4.49-B 1					66.19 66.18 66.17 66.16 66.15 66.14 66.13 66.12 66.11 66.10 66.09 66.08 66.07 66.06 66.05 66.04 66.03 66.02 66.01 66.00
Weg	3.18-D 3.47-A 7					66.67 66.66 66.65 66.64 66.63 66.62 66.61 66.60 66.59 66.58 66.57 66.56 66.55 66.54 66.53 66.52 66.51 66.50 66.49 66.48 66.47 66.46
Weg	11.81-V 4.45-C 1 11.73-V 4.41-C 1					66.57 66.56 66.55 66.54 66.53 66.52 66.51 66.50 66.49 66.48 66.47 66.46
Weg	12.09-V 1.69-C 1					66.42 66.41 66.40 66.39 66.38 66.37 66.36 66.35 66.34 66.33 66.32 66.31 66.30 66.29 66.28 66.27 66.26 66.25 66.24 66.23 66.22 66.21 66.20 66.19 66.18 66.17 66.16 66.15 66.14 66.13 66.12 66.11 66.10 66.09 66.08 66.07 66.06 66.05 66.04 66.03 66.02 66.01 66.00
Weg	2.39-H 0.26-C 3					66.48 66.47 66.46

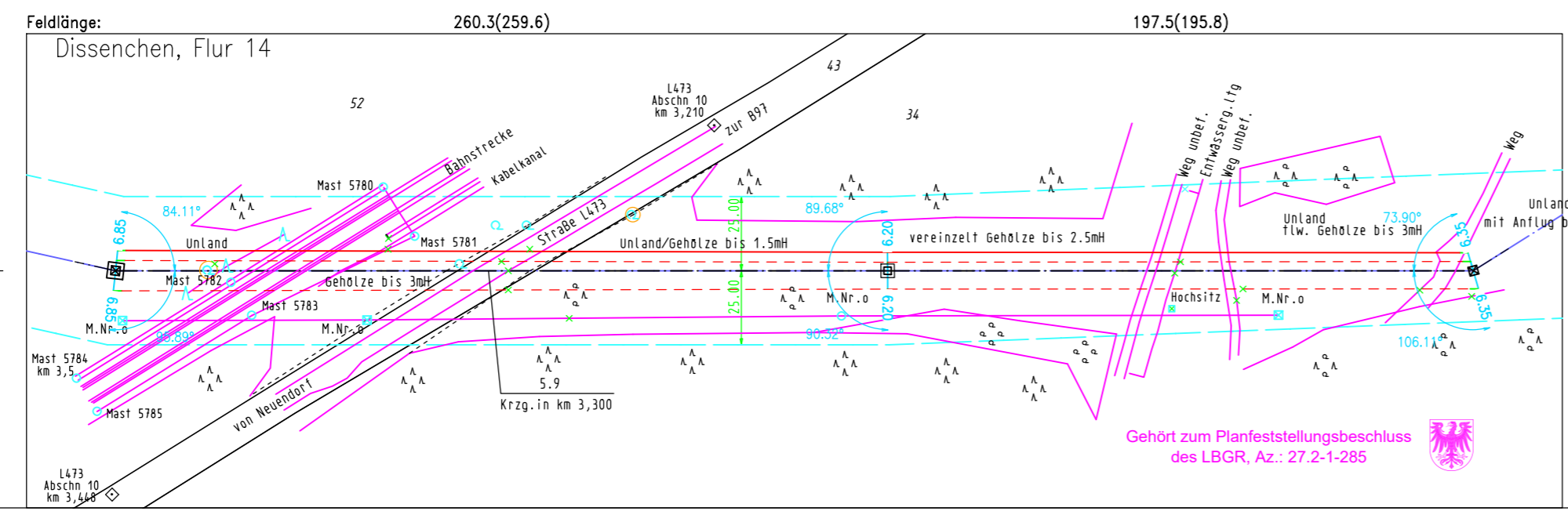

FMPROFIL V8.14.11 (V-Version, BB02763B-04F25E85-79FCE688-4E92A79B-55CBA96F)